

Jens S can offer timing bars, material aluminum, in profiles MXL, XL, L, HTD 3M, 5M, 8M, T5, AT5, T10 and AT10. Other materials on request. For CAD drawings or technical assistance, please contact our technical department.

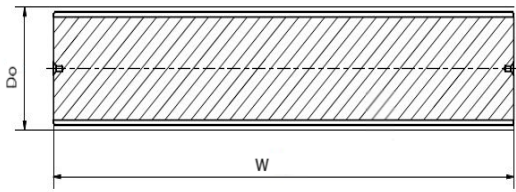

1

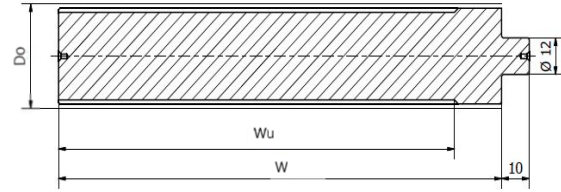

3

MXL - 0,080 (2,032mm)					
Aluminum					
Type	Number of Teeth	Do [mm]	W [mm]	Wu [mm]	Weight [mm]
3	10	6,47	50	75	-
3	11	7,11	50	75	-
3	12	7,76	50	75	-
3	13	8,41	50	75	-
3	14	9,06	50	75	-
3	15	9,7	50	75	-
3	16	10,35	50	75	-
3	17	11	50	75	-
3	18	11,64	50	75	-
3	19	12,29	90	120	-
3	20	12,94	90	120	-
3	21	13,58	90	120	-
3	22	14,23	125	140	-
3	23	14,88	125	140	-
3	24	15,52	125	140	-
3	25	16,17	125	140	-
3	26	16,82	125	140	-
3	27	17,46	125	140	-
3	28	18,11	125	140	-
3	29	18,76	125	140	-
3	30	19,4	125	140	-
3	32	20,7	125	140	-
3	34	21,99	125	140	-
3	35	22,64	132	140	-
3	36	23,29	132	140	-
3	38	24,58	132	140	-
3	40	25,87	132	140	-
3	42	27,17	140	140	-
3	44	28,46	140	140	-
3	45	29,11	140	140	-
3	48	31,05	140	140	-
3	50	32,34	140	140	-
3	60	38,81	160	160	-
3	64	41,4	160	160	-
3	65	42,04	160	160	-
3	70	45,28	160	160	-
3	72	46,57	160	160	-
3	75	48,51	160	160	-
3	90	58,21	160	160	-
3	110	71,15	160	160	-

XL - 1,5" (5,08 mm)					
Steel - Aluminum					
Type	Number of Teeth	Do [mm]	W [mm]	Wu [mm]	Weight [mm]
1	10	16,17	140	140	-
1	11	17,79	140	140	-
1	12	19,4	140	140	-
1	13	21,02	140	140	-
1	14	22,64	140	140	-
1	15	24,25	140	140	-
1	16	25,87	140	140	-
1	17	27,49	140	140	-
1	18	29,11	140	140	-
1	19	30,72	140	140	-
1	20	32,34	140	140	-
1	21	33,96	160	160	-
1	22	35,57	160	160	-
1	23	37,19	160	160	-
1	24	38,81	160	160	-
1	25	40,43	160	160	-
1	26	42,04	160	160	-
1	27	43,66	160	160	-
1	28	45,28	160	160	-
1	29	46,89	160	160	-
1	30	48,51	160	160	-
1	32	51,74	160	160	-
1	33	53,36	160	160	-
1	34	54,98	160	160	-
1	35	56,6	160	160	-
1	36	58,21	160	160	-
1	38	61,45	160	160	-
1	39	63,06	160	160	-
1	40	64,68	160	160	-
1	41	66,3	160	160	-
1	42	67,91	160	160	-
1	43	69,53	160	160	-
1	44	71,15	160	160	-
1	48	77,63	160	160	-
1	56	90,55	160	160	-
1	60	97,02	160	160	-
1	72	116,43	160	160	-

L - 3/8" (9,525 mm)					
Steel - Aluminum					
Type	Number of Teeth	Do [mm]	W [mm]	Wu [mm]	Weight [mm]
1	10	30,32	140	140	-
1	11	33,35	140	140	-
1	12	36,38	160	160	-
1	13	39,41	160	160	-
1	14	42,45	160	160	-
1	15	45,48	160	160	-
1	16	48,51	160	160	-
1	17	51,54	160	160	-
1	18	54,57	160	160	-
1	19	57,61	160	160	-
1	20	60,64	160	160	-
1	21	63,67	160	160	-
1	22	66,7	160	160	-
1	23	69,73	160	160	-
1	24	72,77	160	160	-
1	27	81,86	160	160	-
1	30	90,96	160	160	-

Item no. example XL:

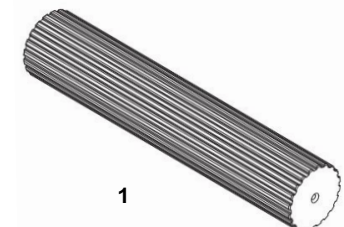
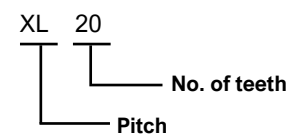

1

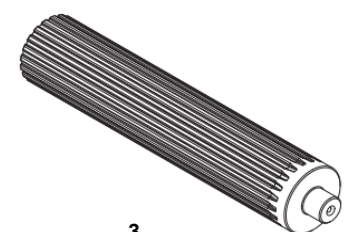

3

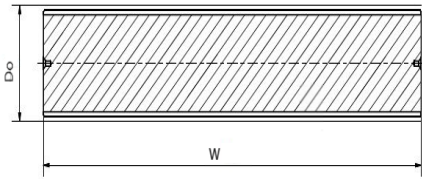

1

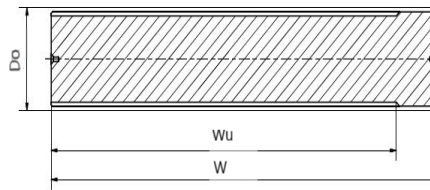

2

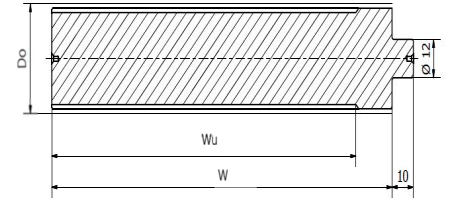

3

3M - Pitch 3 mm					
Aluminum					
Type	Number of Teeth	Do [mm]	W [mm]	Wu [mm]	Weight [mm]
3	9	8,59	75	100	-
3	10	9,5	75	100	-
3	11	10,5	75	100	-
3	12	11,46	100	125	-
3	13	12,41	100	125	-
3	14	13,37	100	125	-
3	15	14,32	100	125	-
3	16	15,28	125	155	-
3	17	16,23	125	155	-
3	18	17,19	125	155	-
3	19	18,14	125	155	-
3	20	19,1	150	165	-
3	21	20,05	150	165	-
3	22	21,01	150	165	-
3	23	21,96	150	165	-
3	24	22,92	150	165	-
3	25	23,87	150	165	-
3	26	24,83	150	165	-
3	27	25,78	150	165	-
3	28	26,74	150	165	-
3	29	27,69	150	165	-
3	30	28,65	175	183	-
3	31	29,6	175	183	-
3	32	30,56	175	183	-
3	33	31,51	175	183	-
3	34	32,47	175	183	-
3	35	33,42	175	183	-
3	36	34,38	200	200	-
3	37	35,33	200	200	-
3	38	36,29	200	200	-
3	39	37,24	200	200	-
3	40	38,2	200	200	-
3	42	40,11	200	200	-
3	44	42,02	200	200	-
3	45	42,97	200	200	-
3	48	45,87	200	200	-
3	50	47,75	200	200	-
3	52	49,66	200	200	-
3	54	51,57	200	200	-
3	56	53,48	200	200	-
3	60	57,3	200	200	-
3	62	59,21	200	200	-
3	64	61,12	200	200	-
3	66	63,03	200	200	-
3	68	64,94	200	200	-
3	70	66,85	200	200	-
3	72	68,75	200	200	-

5M - Pitch 5 mm					
Aluminum					
Type	Number of teeth	Do [mm]	W [mm]	Wu	Weight [kg]
2	12	19,1	150	165	0,1
2	13	20,69	150	165	0,12
2	14	22,28	175	183	0,15
2	15	23,87	175	183	0,18
2	16	25,46	175	183	0,21
2	17	27,06	175	183	0,23
1	18	28,65	200	200	0,29
1	19	30,24	200	200	0,33
1	20	31,83	200	200	0,37
1	21	33,42	200	200	0,41
1	22	35,01	200	200	0,45
1	23	36,61	200	200	0,49
1	24	38,2	200	200	0,54
1	25	39,79	200	200	0,59
1	26	41,38	200	200	0,64
1	27	42,97	200	200	0,7
1	28	44,56	200	200	0,75
1	29	46,15	200	200	0,81
1	30	47,75	200	200	0,87
1	31	49,34	200	200	0,93
1	32	50,93	200	200	1
1	33	52,52	200	200	1,06
1	34	54,11	200	200	1,13
1	35	55,7	200	200	1,2
1	36	57,3	200	200	1,27
1	38	60,48	200	200	1,43
1	40	63,66	200	200	1,59
1	42	66,85	200	200	1,76
1	44	70,03	200	200	1,93
1	45	71,62	200	200	2,03
1	46	73,21	200	200	2,12
1	48	76,39	200	200	2,32
1	50	79,58	200	200	2,52
1	54	85,94	200	200	2,95
1	60	95,49	200	200	3,67
1	62	98,68	200	200	3,92
1	72	114,59	200	200	5,33

8M - Pitch 8 mm					
Aluminum					
Type	Number of teeth	Do [mm]	W [mm]	Wu	Weight [kg]
1	18	45,84	200	200	0,74
1	19	48,38	200	200	0,84
1	20	50,93	200	200	0,93
1	21	53,48	200	200	1,04
1	22	56,02	200	200	1,15
1	23	58,57	200	200	1,26
1	24	61,12	200	200	1,38
1	25	63,66	200	200	1,51
1	26	66,21	200	200	1,64
1	28	71,3	200	200	1,92
1	30	76,39	200	200	2,22
1	32	81,49	200	200	2,55
1	34	86,58	200	200	2,89
1	35	89,13	200	200	3,07
1	36	91,67	200	200	3,26
1	38	96,77	200	200	3,65
1	40	101,86	200	200	4,06
1	44	112,05	200	200	4,95
1	48	122,23	200	200	5,93

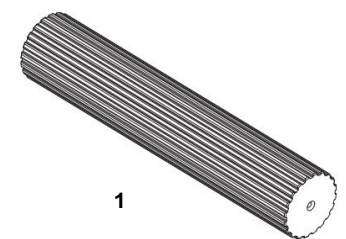

1

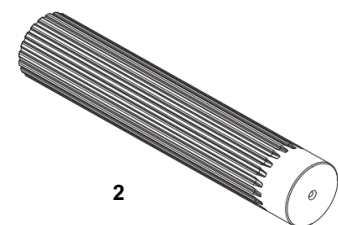

2

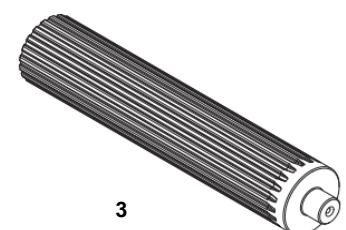

3

Item no. example 5M:

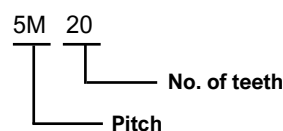

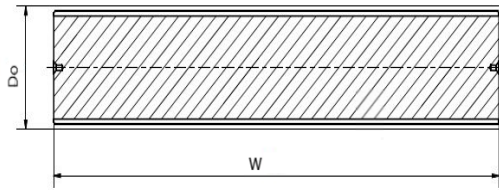

1

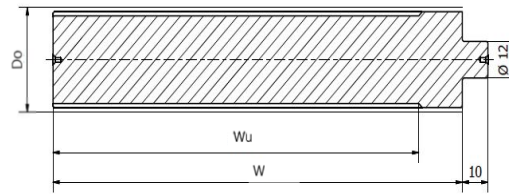

3

T2,5 - Pitch 2,5 mm					
Aluminum					
Type	Number of Teeth	Do [mm]	W [mm]	Wu [mm]	Weight [mm]
3	10	796	50	75	-
3	12	9,55	50	75	-
3	13	10,35	50	75	-
3	14	11,14	50	75	-
3	15	11,94	50	75	-
3	16	12,73	50	75	-
3	17	13,53	50	75	-
3	18	14,32	50	75	-
3	19	15,12	90	120	-
3	20	15,92	90	120	-
3	21	16,71	90	120	-
3	22	17,51	125	140	-
3	24	19,1	125	140	-
3	26	20,69	125	140	-
3	27	21,49	125	140	-
3	28	22,28	125	140	-
3	29	23,08	125	140	-
3	30	23,87	125	140	-
3	32	25,46	125	140	-
3	34	27,06	125	140	-
3	35	27,85	132	140	-
3	36	28,65	132	140	-
3	38	30,24	132	140	-
3	40	31,83	132	140	-
3	42	33,42	140	140	-
3	44	35,01	140	140	-
3	45	35,81	140	140	-
3	48	38,2	140	140	-
3	50	39,79	160	160	-
3	60	47,75	160	160	-
3	65	51,73	160	160	-
3	70	55,7	160	160	-
3	72	57,3	160	160	-
3	90	71,62	160	160	-
3	100	79,58	160	160	-

T5 - Pitch 5 mm					
Aluminum					
Type	Number of teeth	Do [mm]	W [mm]	Wu [mm]	Weight [kg]
1	10	15,91	140	140	0,05
1	100	159,15	160	160	8,29
1	11	17,5	140	140	0,06
1	12	19,1	140	140	0,08
1	13	20,69	140	140	0,1
1	14	22,28	140	140	0,11
1	15	23,87	140	140	0,13
1	16	25,47	140	140	0,15
1	17	27,06	140	140	0,17
1	18	28,65	140	140	0,2
1	19	30,24	140	140	0,22
1	20	31,83	160	160	0,29
1	21	33,42	160	160	0,32
1	22	35,01	160	160	0,35
1	23	36,61	160	160	0,39
1	24	38,19	160	160	0,43
1	25	39,79	160	160	0,46
1	26	41,38	160	160	0,51
1	27	42,97	160	160	0,55
1	28	44,56	160	160	0,59
1	29	46,16	160	160	0,64
1	30	47,15	160	160	0,69
1	32	50,93	160	160	0,79
1	34	54,11	160	160	0,89
1	35	55,71	160	160	0,95
1	36	57,3	160	160	1,01
1	37	58,89	160	160	1,07
1	38	60,48	160	160	1,13
1	40	63,66	160	160	1,26
1	42	68,85	160	160	1,39
1	44	70,03	160	160	1,53
1	45	71,62	160	160	1,61
1	46	73,21	160	160	1,68
1	48	76,39	160	160	1,84
1	50	79,58	160	160	2
1	60	95,49	160	160	2,92
1	72	114,59	160	160	4,24
1	80	127,32	160	160	5,26
1	90	143,24	160	160	6,69

T10 - Pitch 10 mm					
Aluminum					
Type	Number of teeth	Do [mm]	W [mm]	Wu	Weight [kg]
1	10	31,83	140	140	0,22
1	11	35,01	140	140	0,27
1	12	38,19	140	140	0,33
1	13	41,38	140	140	0,4
1	14	44,56	160	160	0,54
1	15	47,74	160	160	0,63
1	16	50,93	160	160	0,72
1	17	54,11	160	160	0,83
1	18	57,29	160	160	0,94
1	19	60,47	160	160	1,05
1	20	63,66	160	160	1,18
1	21	66,84	160	160	1,31
1	22	70,02	160	160	1,44
1	23	73,21	160	160	1,59
1	24	76,39	160	160	1,74
1	26	82,76	160	160	2,06
1	28	89,12	160	160	2,41
1	30	95,49	160	160	2,79
1	32	101,85	160	160	3,2
1	34	108,22	160	160	3,63
1	36	114,59	160	160	4,09
1	38	120,95	160	160	4,58
1	40	127,32	160	160	5,09
1	45	142,23	160	160	6,5
1	48	152,78	160	160	7,43
1	60	190,98	160	160	11,76
1	72	229,17	160	160	17,08

Item no. example T5:

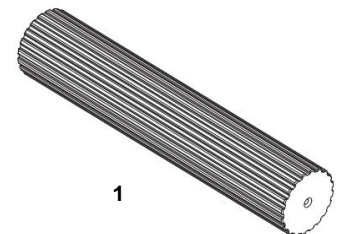
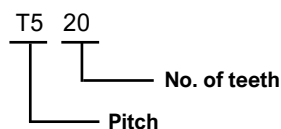

1

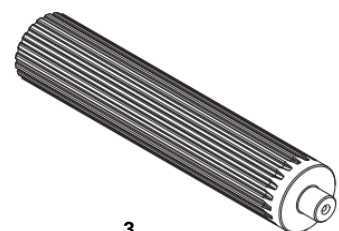

3

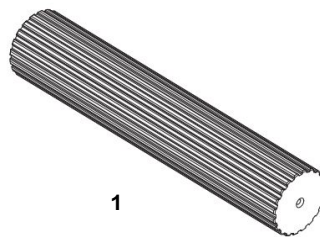
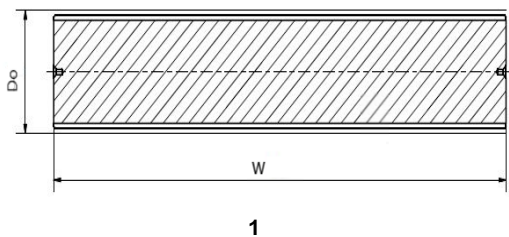

Item no. example AT10:

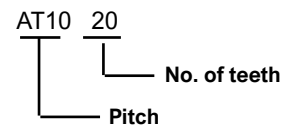

AT10 - Pitch 5 mm					
Aluminum					
Type	Number of teeth	Do [mm]	W [mm]	Wu	Weight [kg]
1	12	19,1	140	140	0,08
1	13	20,69	140	140	0,1
1	14	22,28	140	140	0,12
1	15	23,87	140	140	0,14
1	16	25,47	140	140	0,16
1	17	27,06	140	140	0,18
1	18	28,65	140	140	0,2
1	19	30,24	140	140	0,23
1	20	31,83	160	160	0,29
1	21	33,42	160	160	0,33
1	22	35,01	160	160	0,36
1	23	36,61	160	160	0,4
1	24	38,19	160	160	0,43
1	25	39,79	160	160	0,47
1	26	41,38	160	160	0,52
1	27	42,97	160	160	0,56
1	28	44,56	160	160	0,6
1	29	46,16	160	160	0,65
1	30	47,15	160	160	0,7
1	31	49,34	160	160	0,75
1	32	50,93	160	160	0,8
1	33	52,52	160	160	0,85
1	34	54,11	160	160	0,91
1	35	55,71	160	160	0,96
1	36	57,3	160	160	1,02
1	38	60,48	160	160	1,14
1	40	63,66	160	160	1,27
1	42	68,85	160	160	1,41
1	44	70,03	160	160	1,55
1	45	71,61	160	160	1,63
1	46	73,21	160	160	1,7
1	48	76,39	160	160	1,86
1	50	79,58	160	160	2,02
1	52	82,76	160	160	2,19
1	54	85,94	160	160	2,37
1	55	87,54	160	160	2,46
1	56	89,13	160	160	2,55
1	58	92,31	160	160	2,74
1	60	95,49	160	160	2,94
1	62	98,68	160	160	3,14
1	64	101,86	160	160	3,36
1	65	103,45	160	160	3,46
1	70	111,41	160	160	4,03
1	72	114,59	160	160	4,27

AT10 - Pitch 10 mm					
Aluminum					
Type	Number of teeth	Do [mm]	W [mm]	Wu	Weight [kg]
1	14	44,56	160	160	0,55
1	15	47,74	160	160	0,64
1	16	50,93	160	160	0,73
1	17	54,11	160	160	0,84
1	18	57,29	160	160	0,95
1	19	60,47	160	160	1,07
1	20	63,66	160	160	1,19
1	21	66,84	160	160	1,32
1	22	70,02	160	160	1,46
1	23	73,21	160	160	1,61
1	24	76,39	160	160	1,76
1	25	79,58	160	160	1,92
1	26	82,76	160	160	2,08
1	27	85,94	160	160	2,26
1	28	89,12	160	160	2,44
1	29	92,31	160	160	2,62
1	30	95,49	160	160	2,82
1	31	98,68	160	160	3,02
1	32	101,85	160	160	3,22
1	33	105,04	160	160	3,44
1	34	108,22	160	160	3,66
1	35	111,41	160	160	3,89
1	36	114,59	160	160	4,12
1	37	117,77	160	160	4,36
1	38	120,95	160	160	4,61
1	40	127,32	160	160	5,13
1	41	130,51	160	160	5,4
1	42	133,69	160	160	5,67
1	44	140,06	160	160	6,24
1	45	142,23	160	160	6,54
1	46	146,42	160	160	6,84
1	48	152,78	160	160	7,47
1	50	159,15	160	160	8,13
1	51	162,34	160	160	8,46
1	52	165,52	160	160	8,81
1	54	171,89	160	160	9,52
1	55	175,07	160	160	9,88
1	56	178,25	160	160	10,26
1	57	181,44	160	160	10,63
1	58	184,62	160	160	11,02
1	59	187,8	160	160	11,41
1	60	190,98	160	160	11,81
1	62	197,35	160	160	12,63
1	70	222,82	160	160	16,19
1	75	238,73	160	160	18,63